



SIMPLIFIED
INNOVATIONS!

SCS MARBLE
SINTERED COMPACT SURFACE

Simpolo[®]
ceramics

VERSATILE SIZES AND SURFACES FOR INNOVATIVE SPACES.

SINTERED COMPACT SURFACE is one of the most innovative and versatile surface covering material invented in this century and Simpolo is the first company in India to introduce the same.

All natural marbles, granites and other varieties of stones are created in thousands of years by nature through extreme heat and dynamic pressure.

SINTERED COMPACT SURFACE is made by accelerating this process in factories, through the use of finest mix of natural raw materials' (Plastic clay component > 20%) and compacting them to very high pressure by using gea-lamina 44,000 tones hydraulic presses and sintering (vitrification) through heat treatment.

SCS MARBLE

SINTERED COMPACT SURFACE

SURFACE ART
MARBLE \ CONCRETE \ WOOD

SIZE
80x160cm \ 120x120cm \ 20x160cm

TECHNICAL FEATURES



For wall application



For floor application



Sintering technology



Impact resistance



Fine detailing



Stain resistant



Water resistant



More glossiness



CONCRETE 80x160cm



WOOD 20x160cm

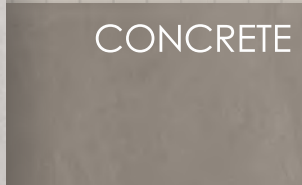

CONCRETE 120x120cm



MARBLE 120x120cm



MARBLE 80x160cm

SIMPLIFIED SURFACES !

PERFECT MIXTURE OF TECHNOLOGY AND IMAGINATION.



Wear resistant



Frost proof

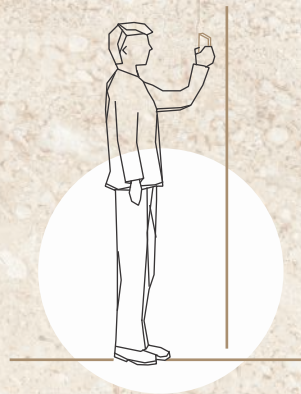

Fully customizable



Stain resistant

It is possible now to recreate exotic stones, granites, marbles, woods, even metallic surfaces of any design, finish, texture and colours in sizes never imagined before, with specifications such that many shortcomings of the natural products are fully addressed.



Water proof



Outstanding beauty



Versatile



THE FULL
COORDINATED
SOLUTIONS



FURNITURE \ DOOR \ TABLE
SHELF \ WALL \ FLOOR
COUNTER TOP \ FIRE PLACE

Simpolo brings a wide range of such surfaces and invites architects, engineers, builders and consumers to explore this wonder of modern world which is fast becoming the first choice for all modern houses and projects.

APPLICATION AREAS

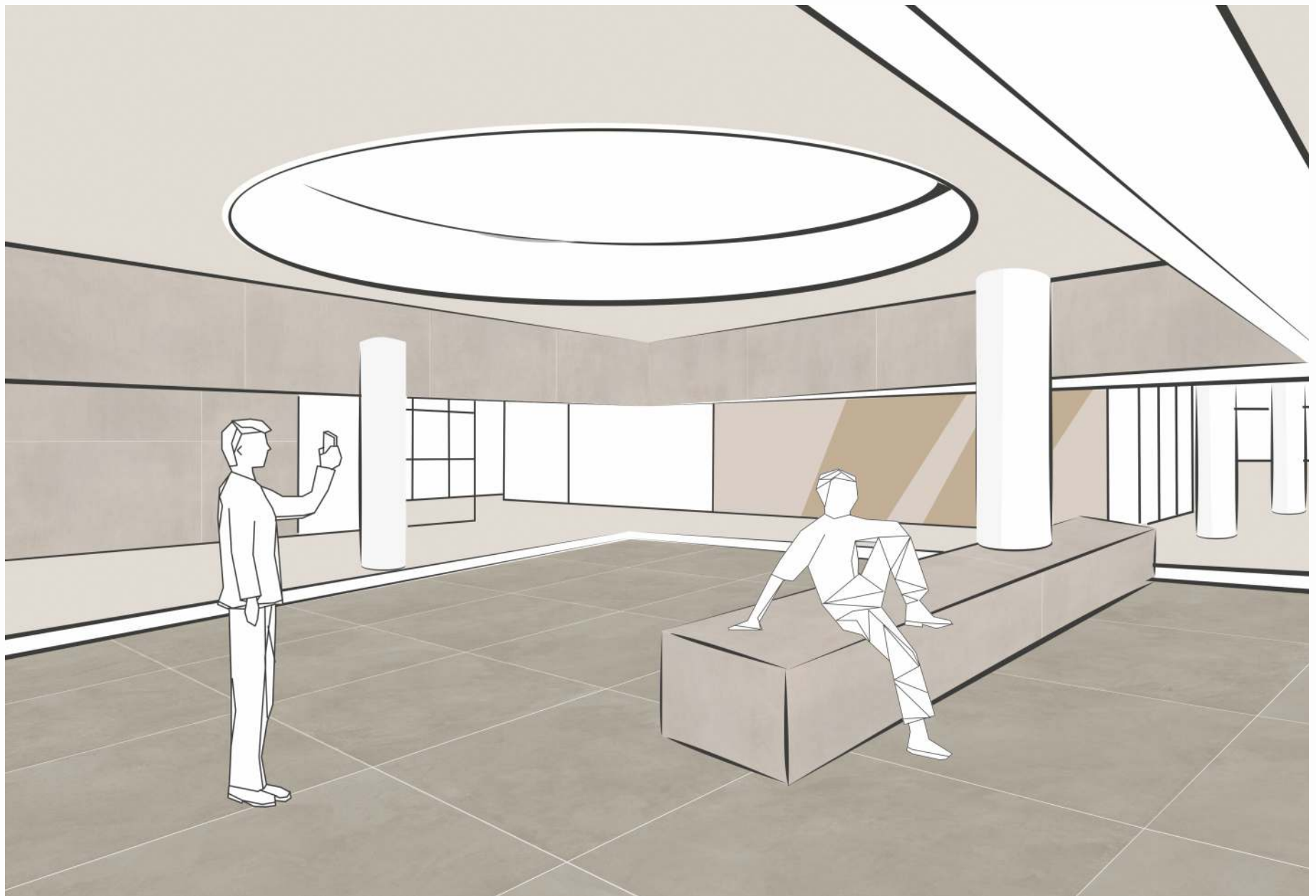



● **SILK POLISH**

● **HIGH GLOSSY**

SCS MARBLE
SINTERED COMPACT SURFACE

80x160 cm

798x1598mm

BEAUTY DOES NOT
COME FROM WEALTH
BUT FROM VIRTUE.

This collection with its timeless beauty has so many virtues. It interacts with every style and can cover any surface without limits or boundaries. The natural, substantial, visual and tactile appeal of marble.

SURFACE ART

MARBLE

“BEAUTY IS
FULFILMENT OF A FORM.
A THING IS BEAUTIFUL WHEN IT
FULFILS ITS PURPOSE”

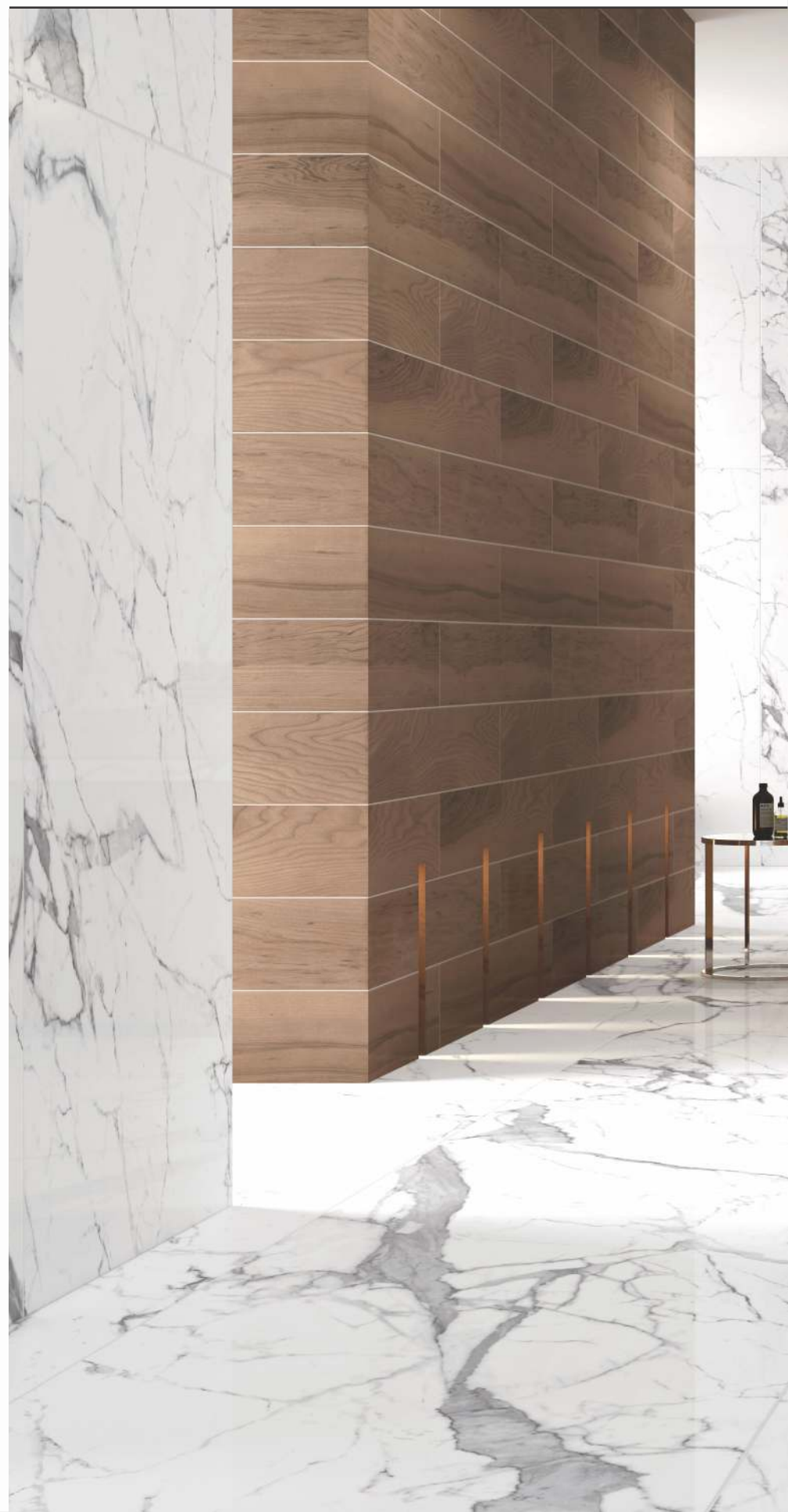

798x1598mm / 80x160cm

Floor & Wall:
MORDEN STATUARIO

SCS MARBLE
SINTERED COMPACT SURFACE





MODERN STATUARIO

798x1598mm / 80x160cm • 9mm

High Glossy, Silk Polish

Random Face



MODERN STATUARIO

1198x1198mm / 120x120cm • 9mm

High Glossy, Silk Polish

Random Face

BOOKMATCHING

SCS MARBLE is made more precious by means of a Bookmatched composition. An aesthetic possibility, which is extremely prestigious, elegant and exclusive. Coverings featuring this effect are a great opportunity to make any surface unforgettable and refined.

MODERN STATUARIO

798x1598mm / 80x160cm • 9mm
High Glossy, Silk Polish
A + B Face



Outstanding beauty

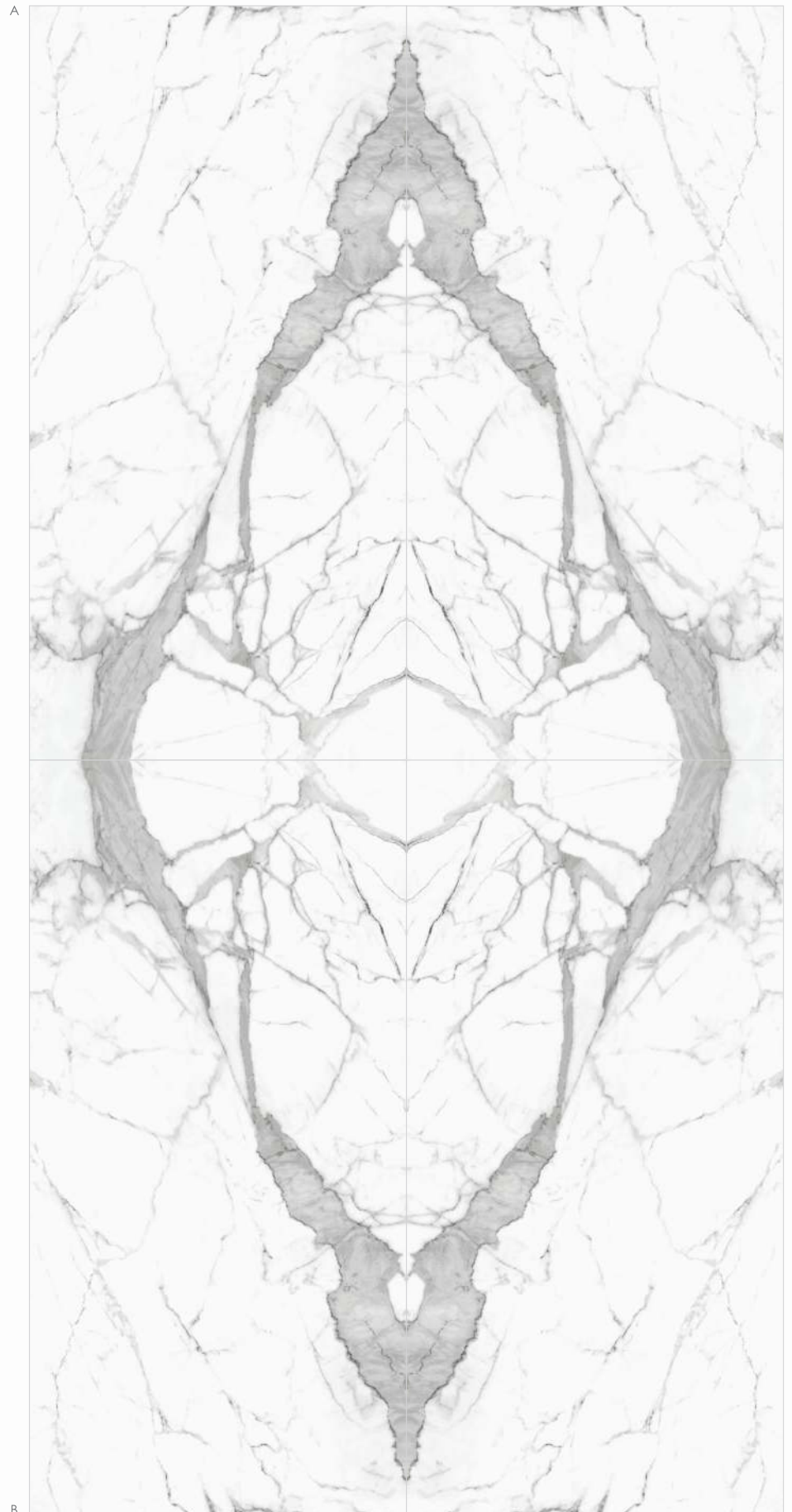



B

A

BRIMBAU BOOKMATCH

798x1598mm / 80x160cm • 9mm

Silk Polish
A + B Face

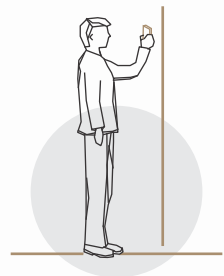

Fully customizable





798x1598mm / 80x160cm

Floor & Wall:
BRIMBAU BOOKMATCH

SCS MARBLE
SINTERED COMPACT SURFACE





-  SOLARIUM
-  MASSAGE
-  SAUNA
-  STONE THERAPY

BLUE BRESCIA BOOKMATCH

798x1598mm / 80x160cm • 9mm

High Glossy, Silk Polish
A + B Face



Versatile





EMPERADOR ASH

798x1598mm / 80x160cm • 9mm

High Glossy, Silk Polish
Random Face



CHAMPION GREY

798x1598mm / 80x160cm • 9mm

High Glossy, Silk Polish
Random Face



798x1598mm / 80x160cm

Floor:
CHAMPION GREY

SCS MARBLE
SINTERED COMPACT SURFACE



SCS MARBLE
SINTERED COMPACT SURFACE

Floor: **ANTIQUE CREMA**,
Wall: **FOREVER BEIGE**

798x1598mm / 80x160cm





FOREVER BEIGE

798x1598mm / 80x160cm • 9mm
High Glossy, Silk Polish
Random Face



ANTIQUE CREMA

798x1598mm / 80x160cm • 9mm
High Glossy, Silk Polish
Random Face



Water proof



BRESCIA SEEMLESS

798x1598mm / 80x160cm • 9mm

High Glossy
Random Face



DIANO PEARL

798x1598mm / 80x160cm • 9mm

High Glossy
Random Face



Frost proof

798x1598mm / 80x160cm

Floor & Wall:
DIANO PEARL

SCS MARBLE
SINTERED COMPACT SURFACE







AURORA LIGHT

798x1598mm / 80x160cm • 9mm
High Glossy, Silk Polish
Random Face



DYNO ROYAL

798x1598mm / 80x160cm • 9mm
High Glossy, Silk Polish
Random Face



Water proof



ARMANI GREY

798x1598mm / 80x160cm • 9mm

High Glossy, Silk Polish

Random Face



ARMANI BRONZE

798x1598mm / 80x160cm • 9mm

High Glossy, Silk Polish

Random Face



Frost proof

798x1598mm / 80x160cm

Floor:
ARMANI BRONZE

SCS MARBLE
SINTERED COMPACT SURFACE



SCS MARBLE
SINTERED COMPACT SURFACE

Floor:
DARK OLIVE

798x1598mm / 80x160cm





DARK OLIVE

798x1598mm / 80x160cm • 9mm

High Glossy
Random Face



DARK EMPERADOR

798x1598mm / 80x160cm • 9mm

High Glossy
Random Face

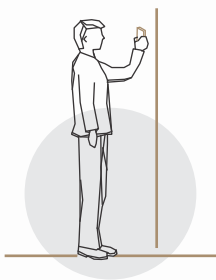

Fully customizable



CREMA DINOVA

798x1598mm / 80x160cm • 9mm

High Glossy
Random Face



ICE DINOVA

798x1598mm / 80x160cm • 9mm

High Glossy
Random Face



Stain resistant

798x1598mm / 80x160cm

Floor & Wall:
ICE DINOVA

SCS MARBLE
SINTERED COMPACT SURFACE



SCS MARBLE
SINTERED COMPACT SURFACE

Floor:
SPARKLE GREY

798x1598mm / 80x160cm





SPARKLE GREY

798x1598mm / 80x160cm • 9mm

High Glossy
Random Face



VINTAGE BROWN

798x1598mm / 80x160cm • 9mm

High Glossy
Random Face



Frost proof



ROYAL BEIGE

798x1598mm / 80x160cm • 9mm

High Glossy
Random Face

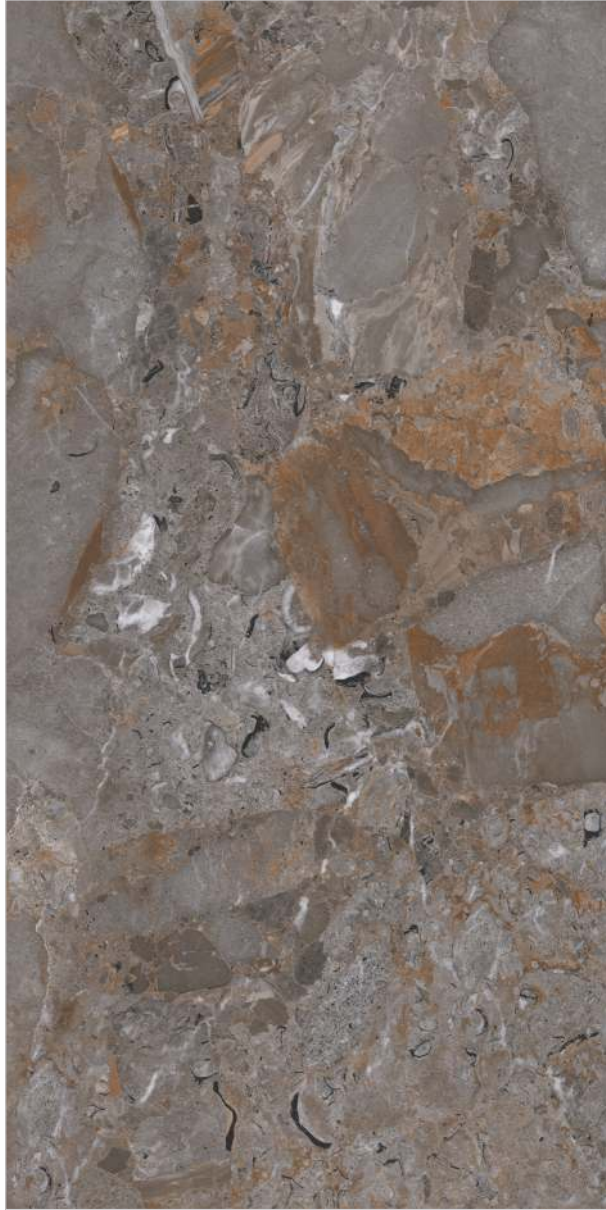

RED ROCK GRIGIO

798x1598mm / 80x160cm • 9mm

High Glossy
Random Face



Stain resistant

798x1598mm / 80x160cm

Floor:
RED ROCK GRIGIO

SCS MARBLE
SINTERED COMPACT SURFACE



SCS MARBLE
SINTERED COMPACT SURFACE

Floor:
BLACK PORTORO

798x1598mm / 80x160cm





Versatile



BLACK PORTORO

798x1598mm / 80x160cm • 9mm

High Glossy
Random Face



CLASSIC TRAVERTINE SILVER

798x1598mm / 80x160cm • 9mm

High Glossy
Random Face



WILLIAM BROWN

798x1598mm / 80x160cm • 9mm

High Glossy
Random Face



Water proof

798x1598mm / 80x160cm

Wall:
CLASSIC TRAVERTINE SILVER

SCS MARBLE
SINTERED COMPACT SURFACE





● SILK POLISH

● HIGH GLOSSY

SCS MARBLE
SINTERED COMPACT SURFACE

120x120 cm

1198x1198mm

THE ETERNAL SOUL
OF A PROJECT
WITHOUT BOUNDARIES.

We are continuing the journey that has led us to create SCS Marble. This is another step beyond the objective of reaching the beauty of material. They have the capacity to make any environment special.

SURFACE ART

MARBLE

SCS MARBLE
SINTERED COMPACT SURFACE

Floor:
EMPERADOR ASH

1198x1198mm / 120x120cm





Outstanding beauty

EMPERADOR ASH

1198x1198mm / 120x120cm • 9mm
High Glossy, Silk Polish
Random Face



CHAMPION GREY

1198x1198mm / 120x120cm • 9mm
High Glossy, Silk Polish
Random Face





Versatile

FOREVER BEIGE

1198x1198mm / 120x120cm • **9mm**
High Glossy, Silk Polish
Random Face



ARMANI GREY

1198x1198mm / 120x120cm • **9mm**
High Glossy, Silk Polish
Random Face

1198x1198mm / 120x120cm

Floor:
ARMANI GREY

SCS MARBLE
SINTERED COMPACT SURFACE







Water proof

ANTIQUA CREMA

1198x1198mm / 120x120cm • **9mm**
High Glossy, Silk Polish
Random Face



BOTTOCHINO CLASSICA

1198x1198mm / 120x120cm • **9mm**
High Glossy
Random Face





Frost proof

DYNO ROYAL

1198x1198mm / 120x120cm • 9mm
High Glossy, Silk Polish
Random Face



BLUE BRESCIA

1198x1198mm / 120x120cm • 9mm
High Glossy
Random Face

1198x1198mm / 120x120cm

Floor & Wall:
DYNO ROYAL

SCS MARBLE
SINTERED COMPACT SURFACE



SCS MARBLE
SINTERED COMPACT SURFACE

Floor:
BRESCIA SEEMLESS

1198x1198mm / 120x120cm



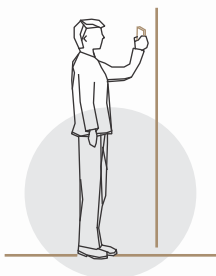

Fully customizable

BRESCIA SEEMLESS

1198x1198mm / 120x120cm • 9mm
High Glossy
Random Face

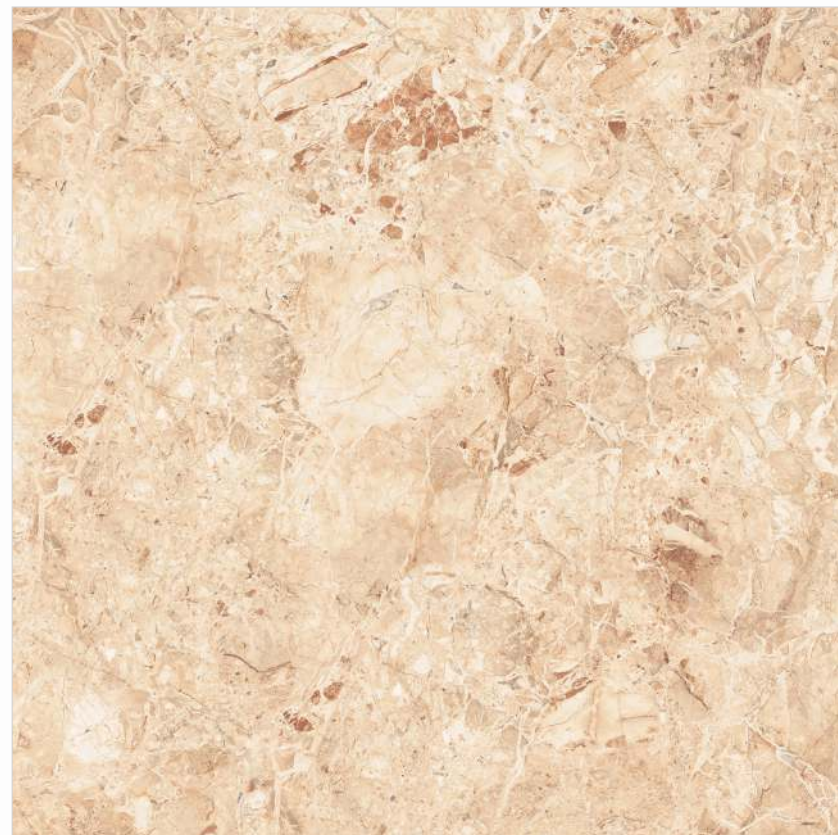

DIANO PEARL

1198x1198mm / 120x120cm • 9mm
High Glossy
Random Face





ICE DINOVA

1198x1198mm / 120x120cm • **9mm**
High Glossy
Random Face

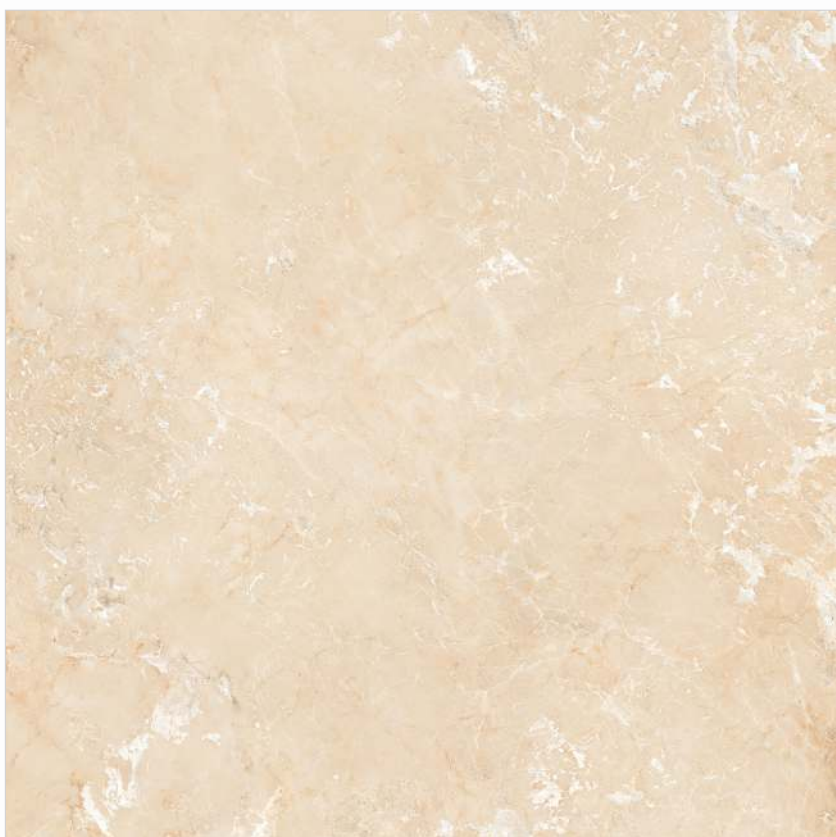

CREMA DINOVA

1198x1198mm / 120x120cm • **9mm**
High Glossy
Random Face

1198x1198mm / 120x120cm

Floor:
CREMA DINOVA

SCS MARBLE
SINTERED COMPACT SURFACE



SCS MARBLE
SINTERED COMPACT SURFACE

Floor & Wall:
ARMANI BRONZE

1198x1198mm / 120x120cm



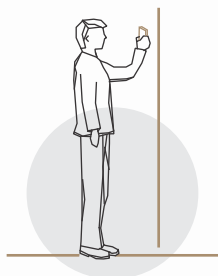

Fully customizable

ARMANI BRONZE

1198x1198mm / 120x120cm • 9mm
High Glossy, Silk Polish
Random Face



◎ MATT

SCS CONCRETE
SINTERED COMPACT SURFACE

80x160 cm

798x1598mm

|

**GUARANTEED
TO MAKE A
LASTING IMPRESSION.**

The collections offer a architectural and urban variety of textural effects so as to always find the right uncompromising inspiration. Each material is a prototype of beauty.

SURFACE ART

CONCRETE



FIRED CONCRETE SILVER

798x1598mm / 80x160cm • 9mm

Matt

Random Face



FIRED CONCRETE ASH

798x1598mm / 80x160cm • 9mm

Matt

Random Face

798x1598mm / 80x160cm

Floor:
FIRED CONCRETE SILVER

SCS CONCRETE
SINTERED COMPACT SURFACE







FIRED CONCRETE BIANCO

798x1598mm / 80x160cm • 9mm

Matt

Random Face



FIRED CONCRETE CALCE

798x1598mm / 80x160cm • 9mm

Matt

Random Face

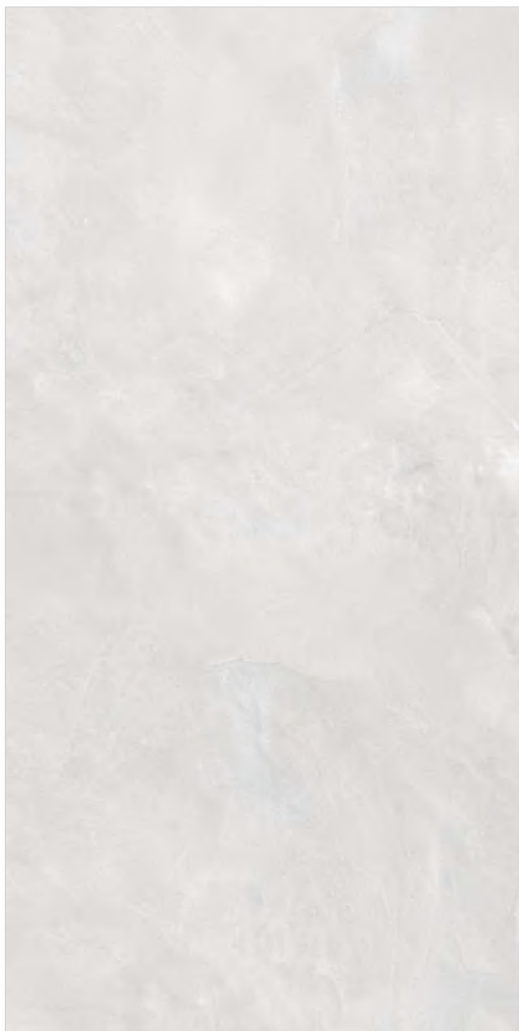

POZZOLANA SMOKE

798x1598mm / 80x160cm • 9mm

Matt

Random Face



POZZOLANA GRIS

798x1598mm / 80x160cm • 9mm

Matt

Random Face



POZZOLANA NERO

798x1598mm / 80x160cm • 9mm

Matt

Random Face

798x1598mm / 80x160cm

Floor:
POZZOLANA NERO

SCS CONCRETE
SINTERED COMPACT SURFACE



SCS CONCRETE
SINTERED COMPACT SURFACE

Floor:
POZZOLANA TOBACCO

798x1598mm / 80x160cm





POZZOLANA CREMA

798x1598mm / 80x160cm • 9mm

Matt

Random Face



POZZOLANA BURLY

798x1598mm / 80x160cm • 9mm

Matt

Random Face



POZZOLANA TOBACCO

798x1598mm / 80x160cm • 9mm

Matt

Random Face

● MATT

SCS CONCRETE
SINTERED COMPACT SURFACE

120x120 cm

1198x1198mm

INSPIRED BY THE
ARCHITECTURE AND
SEAMLESS SIMPLICITY

Stunning color options and Matt finish to lend your designs character and exclusive elegance. The ideal choice for retail outlets, restaurants, shopping centres, large architectural spaces, and any other setting where the design needs to be stylish and to stand out.

SURFACE ART

CONCRETE



POZZOLANA SMOKE

1198x1198mm / 120x120cm • 9mm

Matt

Random Face



POZZOLANA GRIS

1198x1198mm / 120x120cm • 9mm

Matt

Random Face



POZZOLANA NERO

1198x1198mm / 120x120cm • 9mm

Matt

Random Face

1198x1198mm / 120x120cm

Floor:
POZZOLANA GRIS

SCS CONCRETE
SINTERED COMPACT SURFACE



SCS CONCRETE
SINTERED COMPACT SURFACE

Floor: **POZZOLANA TOBACCO**,
Wall: **POZZOLANA CREMA**

1198x1198mm / 120x120cm



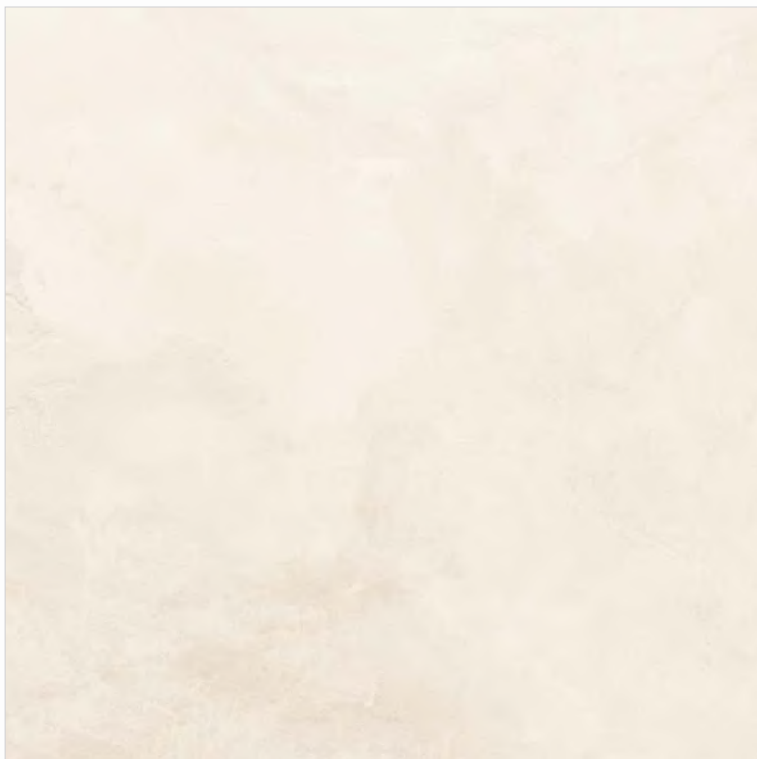

POZZOLANA CREMA

1198x1198mm / 120x120cm • 9mm

Matt

Random Face



POZZOLANA BURLY

1198x1198mm / 120x120cm • 9mm

Matt

Random Face

POZZOLANA TOBACCO

1198x1198mm / 120x120cm • 9mm

Matt

Random Face





● MATT

SCS WOODS
SINTERED COMPACT SURFACE

20x160 cm

198x1598mm

|

AESTHETIC CONCEPT OF REFINEMENT AND SIGNIFICANT

The combination of these very special series instantly evoke a sense of nature wherever they are laid. We work each day to transmit these values to our customers, focusing on innovation and differentiation that set us apart from the rest.

SURFACE ART

WOODS



OAK WOOD GOLDEN

198x1598mm / 20x160cm ▫ 9mm

Matt

Random Face



OAK WOOD BROWN

198x1598mm / 20x160cm ▫ 9mm

Matt

Random Face

198x1598mm / 20x160cm

Floor:
OAK WOOD BROWN

SCS WOODS
SINTERED COMPACT SURFACE



SCS WOODS
SINTERED COMPACT SURFACE

Floor:
SEQUILA BROWN

198x1598mm / 20x160cm





SEQUILA ONICATA

198x1598mm / 20x160cm • 9mm

Matt

Random Face



SEQUILA BROWN

198x1598mm / 20x160cm • 9mm

Matt

Random Face

INSTALLATION SUGGESTIONS

TRADITIONAL FLOOR LAYING

Laying SIMPOLO SCS requires similar laying conditions to those required for traditional formats. Requires the adhesive to be applied both on the setting bed and on the back of the tile.

SIMPOLO Tiles for flooring require the following conditions:

- A flat surface;
- Clean and free from dust, scraps and any lumps of cement;
- The setting bed must be uniform and have already undergone the drying shrinkage process;
- Repair of any cracks;
- Any uneven parts on the surface must be filled with suitable levelling compounds.

INSTRUMENTS REQUIRED

- Cement-based powder adhesive for full spread
- 3x3mm square toothed trowel and 15mm round toothed trowel;
- Frame with suction cups for handling or double suction cups;
- Non-bounce plastic mallet 170x370mm;
- Levelling system: base clip + wedge + pliers.

Processing stages

BONDING TO THE FLOOR

- 1) Ensure that the surface to be covered is solid, flat and free from dust and oil/grease.
- 2) Use the adhesives described above mixed according to the specifications indicated in the technical data sheet of the chosen adhesive.
- 3) Spread the adhesive onto the surface to be covered with a 15mm round toothed trowel across an area of 5/10 cm more than the dimensions of the Tile.
- 4) With the tile in a vertical position on the handling frame, spread the adhesive onto the back of the slab with a 3x3mm square toothed trowel.
- 5) Using the frame with suction cups, bring the tile into a horizontal position and lay it.
- 6) To guarantee uniform bonding of the slab, the special 170x370mm non-bounce plastic mallet must be used, tapping from the middle towards the edges so as to remove any air pockets between the back of the tile, the adhesive and the surface to be tiled.
- 7) Using the levelling system.

LEVELLING SYSTEM

The levelling system aims to guarantee perfectly levelled floors simply and quickly, eliminating any unevenness between the tiles. The levelling system is strongly recommended for laying SIMPOLO Tiles.

Instruments required

- Base clip;
- Wedge;
- Adjustable pliers for installing floors/wall tiles.

Application of the levelling system

Positioning the base clip:

- a) After spreading the adhesive, insert the base clip below the SIMPOLO tile on the 4 sides.
- b) Depending on the format of the tile, position one or more supports for each side of the tile.
- c) Position the tile.

Inserting the wedge:

- a) Insert the wedge in the slot of the support, taking care not to exceed the breaking point.
- b) To make inserting the wedge easier, it is recommended to use the adjustable pliers.

Removing the support:

- a) Once the adhesive has dried, the protruding part of the support can be separated from the base clip by tapping with your foot in line with the joint.

GENERAL ADVICE FOR GROUTING

Pay attention while choosing joint sealants: check the technical sheets, choose them shade matched and follow carefully the recommended cleaning times, as many new generation coloured sealants contain pigments and additives that can be very strong. For polished/glossy surfaces do not use epoxy grouts or synthetic based flexible mortars (Flexfughe) and do not add additives/latexes to the grout, as they make the removal of residues with standard detergents very difficult. However, should you decide to use them, it is recommended to make a previous test off site



CLEANING AND MAINTENANCE

Introduction

All SIMPOLO materials are easy to clean and maintain. Regular cleaning highlights the aesthetic features of the material and gives the floor an exceptional shine.

Initial cleaning

The initial cleaning done immediately after the flooring laid is of essential importance for removing all mortar, adhesives and epoxy residues that may be left in the joints. In this initial phase, we recommend that you use an acid product such as DETERDEK, in a 1:5 concentration. Rub energetically to obtain the maximum cleaning. After washing the floor, which is just as important, rinse thoroughly with plenty of water to remove all traces of the detergent used. These steps are recommended for all SIMPOLO collections.

Maintenance and care

Thanks to the characteristics of the production process (high firing temperature, raw materials of great quality, sinterizing process), the surface of SIMPOLO material is waterproof (the water absorption is minimum). Therefore the dirt cannot penetrate but it is necessary to remove it from the surface. For this procedure do not use detergents containing waxes or waxing products, in order to avoid the forming of greasy layers; for choosing the most appropriate detergent refer to the following chapters. After the installation of floors, particularly of those made with polished materials, the surfaces should be adequately protected with particle board or other suitable materials in order to protect them from dirt and on-site processing. This prevents damage caused by subsequent processing

General recommendations

For commercial and heavily used surface areas such as airports, hospitals, supermarkets, and any public spaces with heavy foot traffic which are thus subject to considerable soiling, it is necessary to use automatic cleaning machines with suction of the washing liquids.

This allows not only deep cleaning, but also the continuous removal of liquids containing substances that cause soiling, thus preventing the formation of films which are very difficult to remove. Any detergent on the market can be used in the desired concentration for cleaning the high technology sinterized SIMPOLO products, with the exception of HYDROFLUORIC acid (HF) or its compounds, according to UNI-EN 176 standards. In order to keep costs limited and speed up maintenance operations, the concentration of the detergent must always be as low as possible. For raised floors we suggest to choose bright or polished surfaces in large sizes: these materials can be dry cleaned or with the minimum use of liquids. After the floor is laid it is necessary to make a very accurate initial cleaning with proper products.

Matt materials

For these materials, after completing the steps described in the section "Initial Cleaning", you only need to clean the floor with hot water containing small quantities of an alkaline detergent such as FILA CLEANER in a concentration 1:200. On these types of surface it is not advisable to apply a waterproofing product: the absence of porosity causes the waterproofing agent to deposit on the surface in an uneven way and to have unpleasant aesthetic effects.

SCS MARBLE

SINTERED COMPACT SURFACE

80x160cm | 120x120cm | 20x160cm

PRODUCT INTRODUCTION

Sintered compact surface is one of the most innovative and versatile surface covering material invented in this century and Simpolo is the first company in India to introduce the same.

All Natural Marbles, Granites and other varieties of stones are created in thousands of years by nature through Extreme heat and dynamic pressure.

SCS MARBLE

SINTERED COMPACT SURFACE



SCS CONCRETE

SINTERED COMPACT SURFACE



SCS WOODS

SINTERED COMPACT SURFACE



SINTERING TECHNOLOGY

The latest Sintering Technology is capable of reaching very high temperatures up to 1225°C. and above, therefore the technical characteristics of ceramics are strengthened and amplified. The resultant product has high strength with certain amount of Elastic flexibility.



IMPACT RESISTANCE

This material has incredible Strength, MOR is 40N/mm² (Granite is 13.8N/mm²), breaking strength 2000N (at least 30% to 40% better than Granite) and an impact resistance of 0.55.



ZERO WATER ABSORPTION (<0.05%)

The sintering at exceptionally high temperatures renders the product resistant to Scratching, staining and fading because of it's near zero water absorption (<0.05%) whereas in case of Granite, it is 0.15%.



STAIN RESISTANT

Low porosity makes these sintered surfaces impervious to harsh chemicals like bleach, hydrochloric acid and other cleaning agents. Sintered slabs are able to withstand extreme heat and can be spray painted with no irreversible damage to the material.



For wall application



For floor application



Fine detailing



Stain resistant



Water resistant



More glossiness



SIMPOLO SCS TILES TECHNICAL SPECIFICATION

	CHARACTERISTIC	STANDARD AS PER ISO-13006/ EN14411 GROUP B IS-15622:2017	MEAN VALUE OF SIMPOLO SCS MARBLE	MEAN VALUE OF SIMPOLO SCS CONCRETE & SCS WOODS	TEST METHOD
Regulatory Properties	Deviation In Length & Width	± 0.50%	± 0.10%	± 0.10%	ISO-10545-2
	Deviation In Thickness	± 5.00%	± 4.00%	± 4.00%	ISO-10545-2
	Straightness Of Sides	± 0.50%	± 0.10%	± 0.10%	ISO-10545-2
	Rectangularity	± 0.50%	± 0.10%	± 0.10%	ISO-10545-2
	Surface Flatness	± 0.50%	± 0.20%	± 0.20%	ISO-10545-2
	Color Differences	Unaltered	No Change	No Change	ISO-10545-16
	Glossiness	As Per Mfg.	> 90 %	Min. 4 %	Glossometer
Structural Properties	Water Absorption	≤ 0.50%	≤ 0.20%	≤ 0.20%	ISO-10545-3
	Apparent Density	> 2.00 g/cc	> 2.10 g/cc	> 2.10 g/cc	DIN 51082
Massive Mechanical Properties	Modulus of Rupture	Min 35N/mm ²	Min. 40N/mm ²	Min. 40N/mm ²	ISO-10545-4
	Breaking Strength (≥ 7.5mm)	Min. 1300 N	Min. 2000 N	Min. 2000 N	ISO-10545-4
	Breaking Strength (< 7.5mm)	Min. 700 N	Min. 900 N	Min. 900 N	ISO-10545-4
	Impact Resistance	As Per Mfg.	Min. 0.55	Min. 0.55	ISO-10545-5
Surface Mechanical Properties	Surface Abrasion Resistance	As Per Mfg.	Min. Class - 3	Min. Class - 4	ISO-10545-7
	Moh's Hardness	As Per Mfg.	Min. 4	Min. 5	EN 101
Thermo Hygrometric Properties	Frost Resistance	No Damage	No Damage	No Damage	ISO-10545-12
	Thermal Shock Resistance	No Damage	No Damage	No Damage	ISO-10545-9
	Moisture Expansion	Nil	Nil	Nil	ISO-10545-10
	Thermal Expansion(COE)	Max. 6x10 ⁻⁶	Max. 6x10 ⁻⁶	Max. 6x10 ⁻⁶	ISO-10545-8
	Crazing Resistance	As Per Mfg.	Min. 10 Cycle	Min. 10 Cycle	ISO-10545-11
Chemical Properties	Chemical Resistance	No Damage	No Damage	No Damage	ISO-10545-13
	Stain Resistance	Resistant	Resistant	Resistant	ISO-10545-14
Safety Properties	Slip Resistance	As Per Mfg.	> 0.40	> 0.40 / > R9	ISO-10545-17
	Fire Resistance	As Per Mfg.	Fireproof	Fireproof	N. A.
	Lead & Cadmium given off by glazed tiles	As Per Mfg.	Does Not Yield Pb & Cd	Does Not Yield Pb & Cd	ISO-10545-15

* Glossiness 90 % with nano technology in PGVT, * Except Hydrofluoric Acid & it's compound



PACKING DETAILS

PRODUCT	SIZE	THICKNESS	NO. OF TILES PER BOX	COVERAGE AREA
SIMPOLO VITRIFIED TILES	80x160cm	9mm	2 pcs.	2.55 sq. mtr.
	120x120cm	9mm	2 pcs.	2.87 sq. mtr.
	20x160cm	9mm	8 pcs.	2.53 sq. mtr.

AHMEDABAD

SIMPOLO GALLERY
First Floor, 103, Sumel - 2,
Nr. Gurudwara, S.G. Highway,
Bodakdev, Ahmedabad - 54.
Mob.: +91 79 40037222

BHAVNAGAR

H. F. INTERIORSS
Plote No.36 , "Anjaney", Ground Floor,
Beside D.B. Bath , Nr. Kaliyabid Water tank,
Opp. Victoriya Park, Bhavnagar.
Tel.: +91 278 2560215 / 16
Mob.: +91 99099 93244

COCHIN

SIMPOLO GALLERY
33/2380 A-A1, NH Bypass,
Vyasali Bus Stope, Chakkraparambu,
Cochin - 682 032.
Mob.: +91 93493 39938

GANDHIDHAM

SIMPOLO GALLERY
Sec. 1-A, Plot 91, First Floor,
Gandhidham (Kutch).
Mob.: +91 94267 37808

HUBLI

KOLIWAD MARBLE AND GRANITE
Near Manickbag Showroom,
P.B. Road, Vidhyanagar,
Hubli.
Tel.: +91 836 2372580 / 4252580

JAIPUR

GUPTA TILES
76, Rathi Nagar, Gajsinghpura,
Gopalpura Bypass,
Jaipur, Rajasthan.
Mob.: +91 94133 84900

KOLHAPUR

CHANDWANI CERAMIC
Opp. Hotel Shivtara,
Kolhapur Sangli Road
Shrioli Plot No.65/6, Shrioli.
Tel.: +91 98220 42900

NEW DELHI

TECHNO STONE
Khasra No. 12, Fatehpur Beri,
Chattarpur Mandir Road,
Opp. Narayani Devi Charifable Dispnsary &
Canara Bank, New Delhi - 110 074.
Tel.: +91 11 65456660

AGRA

ARAVALI CERAMICS COMPANY
(SIMPOLO GALLERY)
NH. 2, Mauja Kuberpur,
Near Reliance Petrol Pump,
Tehsil Etmadpur, Agra.
Mob.: +91 99971 77711

BHOPAL

SHRI GORAJI MARBLE
Plot No 91 - A,
Airport Main Road,
Near SBI Bank,
Bhopal.
Mob.: +91 84629 40479, +91 81093 44201

CUTTACK

CERAMIC SALES CORPORATION
Plote No.1650/2792,
Gopalpur, NH - 5,
Cuttack - 753 001.
Mob.: +91 92384 99114

GOA (Margao)

SILVER TRADE LINKS
Shop No.17, Desai Residential
& Commercial Complex,
Dongorwado, Near Nehru Stadium,
Fatorda, Margao - Goa.
Tel.: +91 832 2741160
Mob.: +91 93723 34339

HYDERABAD

CERAMIC INC.
HNO#4/70/37,
Adarsh Nagar, Nagole,
Hyderabad.
Tel.: +91 40 65694040 / 5050

JAORA

SHUBH MARBLE AND GRANITE,
30, Industrail Area,
Jaora (M.P.).
Mob.: +91 98275 62933

KOLKATA

SIMPOLO GALLERY
Ground Floor, D.B.52,
Slate Lake City , Sector 1,
Kolkata - 700 064.
Mob.: +91 90733 53728

NEPAL

JJ MARBLE HOUSE
G.P.O Box No. 56,
14/389, Tokha Road,
Kathmandu, Nepal.
Ph: +977 14381218

BANGLORE

SIMPOLO GALLERY
#79 /1 & 144 /1-9, Kalkere Main Road,
Horamavu Village, Bangalore - 560 043.
Tel.: +91 80 65462222, 65363333
Mob.: +91 99002 31333

BHUBANESWAR

CERAMIC WORLD
602, Rasulgrah,
Opp. Kochilei Market,
Cuttack Road,
Bhubneswar.
Mob.: +91 92384 99102

DHULIYA

VIRAJ CERAMICS
87/6, Opp. Hotel Sheetal,
Parola Road, Balapur,
Dhule - 424 001.
Mob.: +91 98501 80401

GURGAON

SIMPOLO GALLERY
Simpolo House,
C-1, South City,
Gurgaon - 122 001.
Tel.: +91 124 4278820

HYDERABAD

CERAMIC INC.
Solanki Plaza, 8-2-293/K/307,
Kamalapuri Colony,
Opp. Green Bawarchi Hotel,
Hyderabad - 500 073.
Tel.: +91 40 23334040
Mob.: +91 90000 18041

JODHPUR

SUN - DEEP TILES
E-73, Kalptaru Shopping Center,
Shastri Nagar,
Jodhpur - 342 001.
Mob.: +91 96720 11000

MUMBAI

SIMPOLO GALLEY
31/R,Shri Laxmi Jyot Industrial Estate ,
Premises Co - Operative Society Ltd ,
Laxmi Industrial Estate ,New Link Road,
Adheri (W) Mumbai - 400 053.
Tel.: +91 22 40167131

PALAKKAD

M/S. K A V. SHAIK ROWTHER
31/671 Market Road,
Palakkad - 678 014,
Kerala.
Tel.: +91 491 2502301, 2537771

BARODA

SIMPOLO MARKETING
29, Dhanlaxmi Complex,
Opp. Manglaya Hall,
Near Airport Char Rasta,
Harni Road, Baroda.
Mob.: +91 99749 60603

CHIKHLI

PRUTHVI ENTERPRISE
Chikhli Bilimora Road,
Chikhli,
Dist. Navsari.
Tel.: +91 2634 231200
Mob.: +91 98251 79455

ERNAKULAM

KAITHRAN BUILD WARE
1X/600 C Kurumassery - 683 579.
Ernakulam, Kerala.
Tel.: +91 484 2267784
Mob.: +91 94473 01945

HIMMATNAGAR

CERAMIC GALLERY
Sankalp Complex,
Samlaji Highway,
Near Collage, Motupura,
Himmatnagar.
Mob.: +91 99798 93772, +91 99798 75772

INDORE

PARAG
Race Course Road,
Indore.
Fax: +91 731 2547598
Tel.: +91 731 2535659 / 60

KALABURAGI

SIMPOLO
Sy. No. 71 Bilgundi Gardens,
Behind Kharge Petrol Pump,
Sedam Ring Road Circle,
Kalaburagi - Karnataka.
Mob.: +91 89709 41000

NASHIK

THE CERAMIC STUDIO
Shop No.18, Business Bay,
Shrihari Kute Marg,
Tidke Colony, Mumbai Naka,
Nashik - 422 002.
Mob.: +91 88477 88888

PUNE

SRI PARAM MARKETING
Vasant Vastu, Ground Floor,
Near Saubhagya Mangal Karyalay,
Near City International School,
Maharshi Nagar, Pune - 37.
Mob.: +91 90280 11200 / 300

RAJKOT

SIMPOLO GALLERY
Govardhan Society,
Opp. Hill Burg App.,
Nr. Golden Super Market,
Vidhyakunj Main Road, Rajkot.
Mob.: +91 78744 74448

SANGLI

VARDHMAN ENTERPRISE
213, Sangli Kolhapur Road,
Opp. Hyundai Showroom,
Sangli-Ankali.
Tel.: +91 233 2422022 / 20
Mob.: +91 90110 93588, +91 89830 93588

THRISSUR

CLASSIC SANITARY EMPORIUM
Br. Classic Buildware,
11/ 479 -A, Kolothumpady,
Irinjalakuda, Thrissure,
Kerala.
Mob.: +91 98472 10693

VELLORE

KEWAL CHAND VINODTH KUMAR,
"Ambalal Lifestyles",
Perumugai,
Vellore - 632 009.
Mob.: +91 87545 93375

RANCHI

PINK CITY MARBLE
Piska More, Ratu Road,
Ranchi - 834 005.
Mob.: +91 94313 51883, +91 94311 70475

SRI GANGANAGAR

PHOOL CHAND MILL STORE
Lakkar Mandi, Ganesh Talkies Road,
Sri Ganganagar.
Mob.: +91 94140 88743, +91 97828 44424

THRISSUR

MODERN SANITARY
Chettupuzha, Building,
Kuruppam Road, Thressure
Kerala.
Mob.: +91 487 2442507, 3290468

RATLAM

CERAMIC CRAFT
17, College Road,
Ratlam. (M.P.)
Mob.: +91 94251 03719

SURAT

SIMPOLO IMPEX
10 & 11, Shivam Complex,
Nr. State Bank of India, Opp. Vijay Sales,
Rander Road, Surat.
Tel.: +91 261 2760787
Mob.: +91 98257 66254, +91 99796 18009

TRICHY

SHRI RANGA AGENCIES
Shri Ranga Towers,
No. 9, Royal Road ,
Cantonment, Trichy.
Tel.: +91 431 2415751

SANGAMNER

CERAMIC CENTER
Opp. Barf Karkhana,
Mathurabai Nagar, Kasara Dumala,
Akola Road, Sangamner. (M.H.)
Mob.: +91 95616 13633

TIRUPUR

NANDHI PIPES
No.39, Vignesh Nagar,
Kaikattipudur, Tirupur Main Road,
Avinashi - 641 654.
Tel.: +91 4296 275740
Mob.: +91 94432 83885

TRIVANDRUM (Kerala)

TARA SANITARY WARES AND TILES
Goodwill Tower,
Pattom Plamoodu Road,
Pattom, Trivandrum,
Kerala - 695 004.
Mob.: +91 9447055212

CUSTOMER CARE DIVISION

- Product Inquiry
- Dealership Inquiry
- Product Knowledge
- Customer Complaint

Toll Free: 1800 233 2223

Mob.: +91 75748 62982 / 83

Email: customercare@simpolo.net

OUR REPRESENTATIVE

AGRA	+91 72499 03888
AHMEDABAD	+91 99980 23911
AURANGABAD	+91 93268 99024
BANGALORE	+91 93411 69424
BAREILLY	+91 75748 62986
BARODA	+91 99989 51003
BHATINDA	+91 93572 22303
BHOPAL	+91 93030 23222
BHUBANESWAR	+91 99256 23322
BHUJ	+91 97252 40551
BIKANER	+91 74348 51099
BOMBAY	+91 93734 64005
CALICUT	+91 93887 83923
CHANDIGARH	+91 93179 95222
CHENNAI	+91 74348 51094
COCHIN	+91 93493 39938
COIMBATORE	+91 70944 74183
DEHRADUN	+91 93586 66607
DELHI	+91 74348 51072
GOA	+91 93723 34339
GURGAON	+91 74348 51072

GUWAHATI	+91 97488 58796
GWALIOR	+91 85179 74222
HUBLI	+91 93798 32244
HYDERABAD	+91 93464 64191
INDORE	+91 93000 97056
JABALPUR	+91 93298 27222
JAIPUR	+91 74348 51097
JALANDHAR	+91 93572 22303
JODHPUR	+91 95879 25005
KALYAN	+91 93734 64003
KANNUR	+91 93886 46777
KANPUR	+91 74348 51095
KOLHAPUR	+91 93260 08009
KOLKATA	+91 90733 53728
LUCKNOW	+91 93369 95222
LUDHIANA	+91 93572 22303
MADURAI	+91 70944 74180
MANGALORE	+91 93412 99684
MIRA ROAD	+91 93734 64007
MORBI	+91 99980 23914
MYSORE	+91 93411 69424

NAGPUR	+91 93734 64002
NASIK	+91 93703 71122
PATNA	+91 93866 22331
PUNE	+91 93734 64009
PONDICHERRY	+91 70944 74181
RAIPUR	+91 99256 23322
RAJKOT	+91 99980 23910
RANCHI	+91 73600 66902
SILIGURI	+91 90733 53733
SIRSA	+91 93151 11717
SURAT	+91 99980 23915
THRISSUR	+91 93877 12233
TIRUNELVELI	+91 70944 74185
TRIVANDRAM	+91 93493 39938
TRICHY	+91 70944 74182
UDAIPUR	+91 74348 51100
VASI	+91 93734 64003
VIJAYAWADA	+91 93466 08791
VISAKHAPATANAM	+91 93966 35554

VITRIFIED TILES | WALL TILES | SANITARYWARE



Simpolo Vitrified Pvt. Ltd.

Old Ghuntu Road, MORBI - 363 642. (Guj.) INDIA.
Tel: +91 2822 242122, 241622, 243622, Fax: +91 2822 243122
E-mail: files@simpolo.net

MUMBAI

31/R, Shri Laxmi Jyot Industrial Estate Premises Co-operative Society Ltd., Laxmi Industrial Estate,
New Link Road, Andheri (W), Mumbai - 400 053.
Tel.: +91 22 40167131, Fax: +91 22 40167132, E-mail: mumbai@simpolo.net

AHMEDABAD

First Floor, 103, Sumel - 2, Near Gurudwara, S. G. Highway, Bodakdev, Ahmedabad - 380 054.
Tel.: +91 79 40037222, +91 79 40052220, E-mail: ahmedabad@simpolo.net

DELHI

Simpolo House, C-1, South City-1, Gurgaon - 122 001. Haryana.
Tel.: +91 124 4278820, E-mail: delhi@simpolo.net

COCHIN

33/2380 A-A1 NH Bypass, Vysali Bus Stop, Chakkaraparambu, Cochin - 682 032.
Mob.: +91 9349339938, Fax: +91 4844037118, E-mail: cochin@simpolo.net

KOLKATA

Ground Floor, DB - 52, Salt Lake City, Sector 1, Kolkata - 700 064. (W.B.)
Mob.: +91 90733 53728, E-mail: kolkata@simpolo.net

www.simpolo.net | Toll Free No.: 1800-233-2223